

FIRST FLOOR PLAN
BACK OF HOUSE AREA

WAITROSE SALTASH
TAMAR VIEW
SALTASH,
CORNWALL,
PL12 6LD

SCALE 1:100
NOVEMBER 2008

COFFEE SHOP AND
STAFF DINING ROOM TO BE LICENSED
FOR THE SALE AND CONSUMPTION OF
ALCOHOL IN THAT AREA

ALL OTHER AREAS TO BE LICENSED
FOR SALE OF ALCOHOL FOR
CONSUMPTION OFF THE PREMISES
UNLESS OTHERWISE STATED

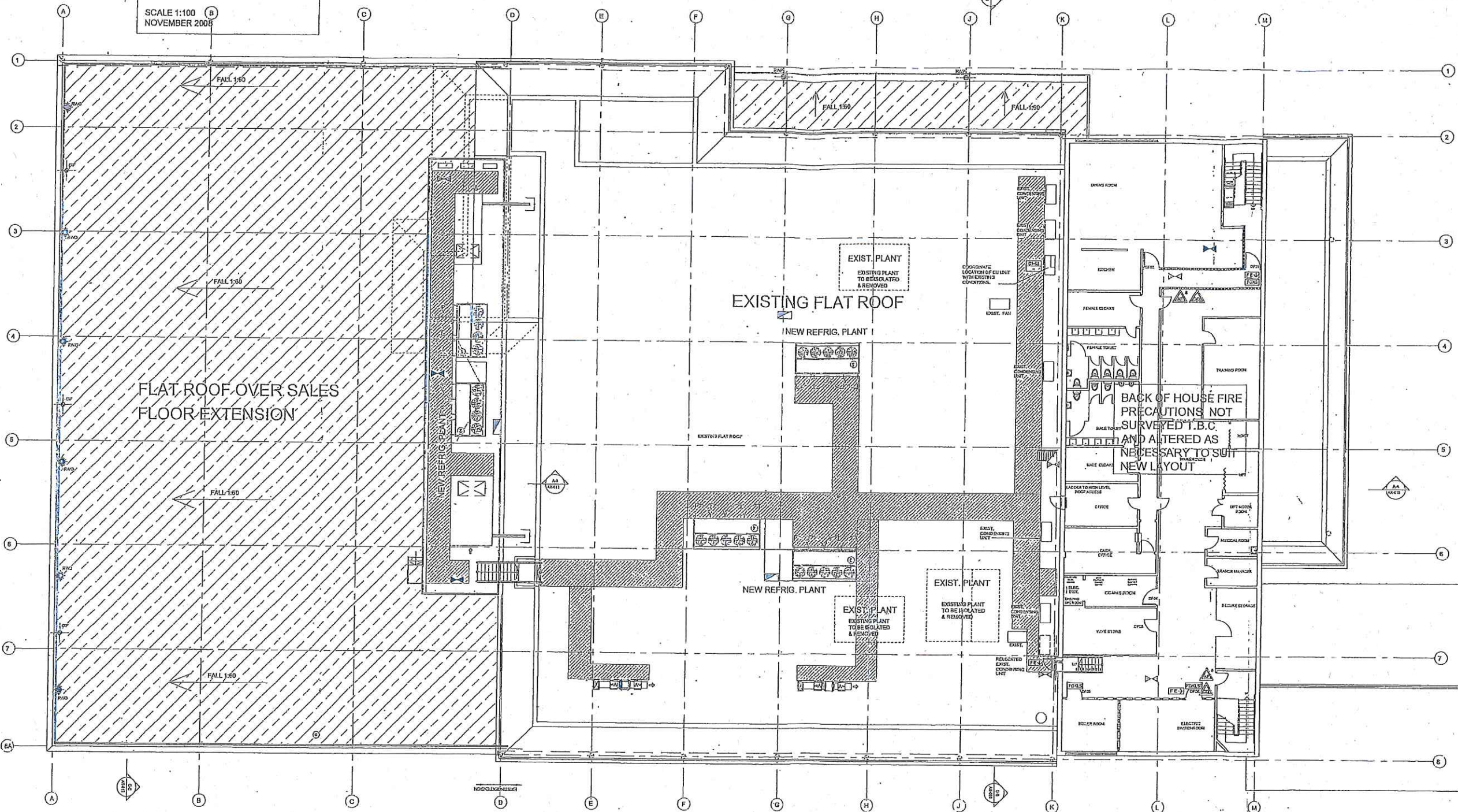

EXTERNAL WALLS TO SALES AREA
NEW POLYURETHANE INSULATED
GLAZED UNITS WITH THERMALLY
BROKEN GLAZING TO MATCH EXISTING,
INSTALLING TO BE SPECIALLY
MATCHED TO EXISTING
CONTRIBUTING TO MATCH EXISTING
COLOR TO MATCH EXISTING

NEW EDDY TO SALES FLOOR EXTENSION AND ENTRANCE
LEARN
NEW EDDY PLY MEMBRANE PLAT ROOF OVER SALES
FLOOR EXTENSION - NEW RAINWATER OUTLETS TO
PREVENT DOWNPIPE

EXISTING WOODWORK AND DOORS
NEW 12.5mm REINFORCED CONCRETE BRICK
SHEATHING IN POLYURETHANE COATED
ALUMINIUM FRAMES, COLOR GREEN TO MATCH EXISTING

ALL INTERNAL FINISHES ARE TO BE MADE GOOD SINCE
WORK HAS BEEN COMPLETED, MATERIALS TO MATCH
EXISTING

ALL MATERIALS FROM DEMOLITION TO BE CLEARED
AWAY AND REMOVED FROM SITE

LEGEND

	60 MIN FIRE COMPARTMENT WALL		FIRE RATED PARTITION TO BE FIXED TO STRUCTURE		NEW FIRE EXIT DOOR - PANIC BAR - WALL FIXED		NEW FIRE DOOR KEEP SHUT		ESCAPE ROUTE
	FIRE RATED PARTITION TO BE FIXED TO STRUCTURE		NEW FIRE EXIT DOOR - PANIC BAR - WALL FIXED		NEW FIRE DOOR KEEP SHUT		NEW FIRE EXIT DOOR - PANIC BAR - WALL FIXED		FIRE RATED PARTITION TO BE FIXED TO STRUCTURE
	NEW FIRE EXIT DOOR - PANIC BAR - WALL FIXED		NEW FIRE DOOR KEEP SHUT		NEW FIRE EXIT DOOR - PANIC BAR - WALL FIXED		NEW FIRE DOOR KEEP SHUT		FIRE RATED PARTITION TO BE FIXED TO STRUCTURE
	NEW FIRE EXIT DOOR - PANIC BAR - WALL FIXED		NEW FIRE DOOR KEEP SHUT		NEW FIRE EXIT DOOR - PANIC BAR - WALL FIXED		NEW FIRE DOOR KEEP SHUT		FIRE RATED PARTITION TO BE FIXED TO STRUCTURE
	NEW FIRE EXIT DOOR - PANIC BAR - WALL FIXED		NEW FIRE DOOR KEEP SHUT		NEW FIRE EXIT DOOR - PANIC BAR - WALL FIXED		NEW FIRE DOOR KEEP SHUT		FIRE RATED PARTITION TO BE FIXED TO STRUCTURE

NOTES

DRAWINGS TO BE READ IN CONJUNCTION WITH
CHILDREN FIRE REPORT REF. FE07/0003
OR LATEST AMENDMENT.

FIRE ALARM TO BE INSTALLED IN
ACCORDANCE WITH BS 5838 PART 1 AND
MANUAL CALL POINTS INSTALLED IN
ACCORDANCE WITH BS 5838 OR BS EN 54-11
ADJACENT TO ALL STOREY EXITS.

EXISTING FIRE DETECTION AND ALARM
SYSTEM TO BS 5838: PART 1 2002 TO L2
STANDARD TO BE EXTENDED TO WHOLE OF
NEW STOREY

EMERGENCY LIGHTING WITH CURRENT
STANDARD OF BS 5266 PART 1 TO BE
EXTENDED TO WHOLE STOREY

WHERE EXISTING PENETRATES FIRE
RESISTING WALLS IT IS TO BE PROVIDED WITH
FIRE DAMPERS OR FIRE RESISTING
ENCLOSURES IN ACCORDANCE WITH BS 5838:
PART 8

ESCAPE SIGNS TO BE PROVIDED IN
ACCORDANCE WITH BS 5459 & BS 5459
ANY STRUCTURE SUPPORTING HEAVY ITEMS
OF PLANT OR PEDESTRIAN MEANS OF ESCAPE
ROUTES ARE ALSO TO BE PROTECTED TO
ACHIEVE 60 MIN FIRE RESISTANCE.

ALL NEW LOADBEARING ELEMENTS OF
STRUCTURE TO ACHIEVE 60 MIN FIRE
RESISTANCE THROUGH FIRE PROTECTIVE
CLADDING OR FLUORESCENT PAINT FINISH.

ALL HOLES THROUGH COMPARTMENT WALLS
OR FLOORS TO BE FIRE STOPPED TO ACHIEVE
60 MIN FIRE RESISTANCE.

ALL EXISTING EMERGENCY LIGHTING, SMOKE
DETECTORS, FIRE ALARMS, FIRE
EXTINGUISHERS, AND CALL POINTS TO BE
MOVED OR REPLACED AS NECESSARY

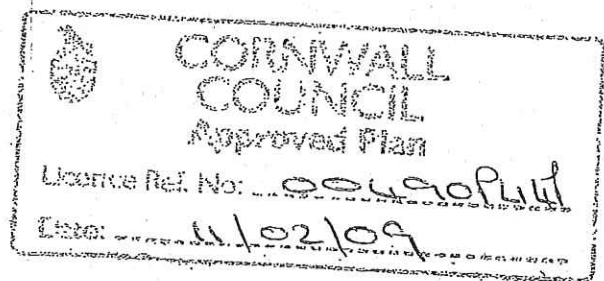

CONSTRUCTION			
PROJECT	WAITROSE SALTASH PROPOSED EXTENSION	DATE	11/02/09
SCALE	AS SHOWN	DESIGNED BY	PA
CHECKED BY	PA	DATE	11/02/09
APPROVED BY	PA	DATE	11/02/09
PROJECT NO.	05484LD-102	CLIENT	WAITROSE SALTASH
ARCHITECT	Bamber and Reddan Architects	ADDRESS	77 Coleridge Street, LONDON SE15
TELEPHONE	020 7143 1700	FAX	020 7143 1717
EMAIL	enquiries@bamandred.com	WEBSITE	www.bamandred.com